

Survey information

**Legend**

**Facing Bricks**

- Tecla Weneberger Kuddingon Red Mult
- Tecla Weneberger Gantfugl Red Stock
- Tecla Weneberger Woodlands Mixture
- Tecla Weneberger Falkington Gold Blend

**Feature Bricks**

All detail bricks, heads & sills to be built using Tecla Weneberger Staffordshire Stream Red

Indicates location of fence

**Roof Tiles**

- Redland Minsterswood Farmhouse Red
- Redland Minsterswood Breckvale Brown Roof Tile
- Redland Minsterswood Slate Grey
- Redland Grovebury Farmhouse Red
- Redland Grovebury Breckvale Brown

**General**

All windows to be White UPVC  
 All Facades to be White UPVC  
 All Rainwater Goods to be White

COUNCIL  
 15 OCT 1990

2 NOV 2009

A 30.10.09 Plots 894/ 916/ 889- 817-820 included in red edge  
 Revision Date Amendment 09/797 Initials HC

**Development THE VILLAGE PH1 & 2**

Location Buckshaw Village, Chorley

Marketing Name

Drawing Title MATERIALS SCHEDULE

Drawing Number BV - 11&2 - MS01

Revision A Scale @ A3 N.T.S

Drawn By HC Date Started OCT 09

Checked by Date

**REDROW HOMES**  
 Redrow Homes (Lancashire) Limited

Redrow House, 14 Eaton Avenue, Buckshaw Village, Chorley, Lancashire, PR7 7NA  
 Tel: 01772 643700 Fax: 01772 643701 Web: www.redrow.co.uk

Legal Disclaimer TBC  
 This layout has been designed after due consideration of our Context & Contents Plan

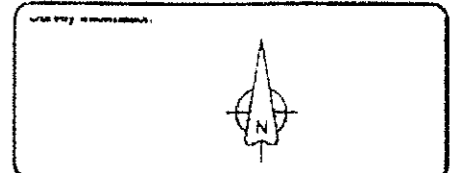
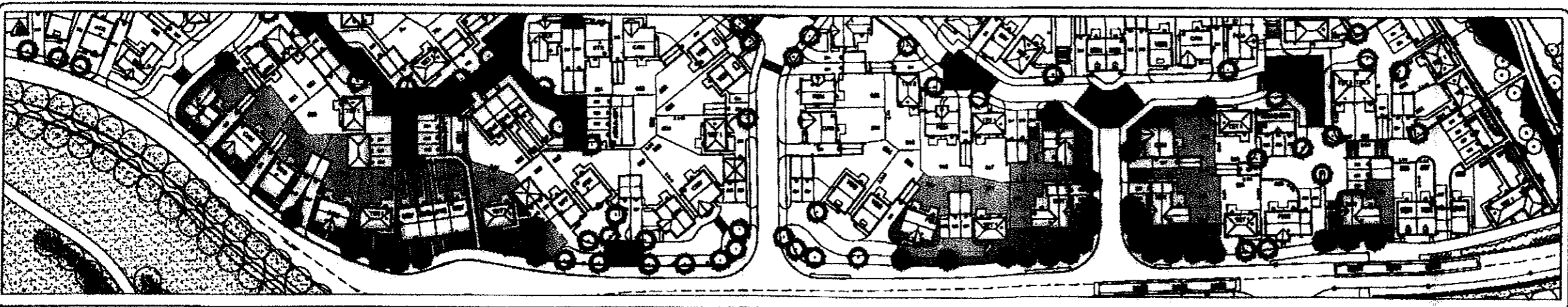
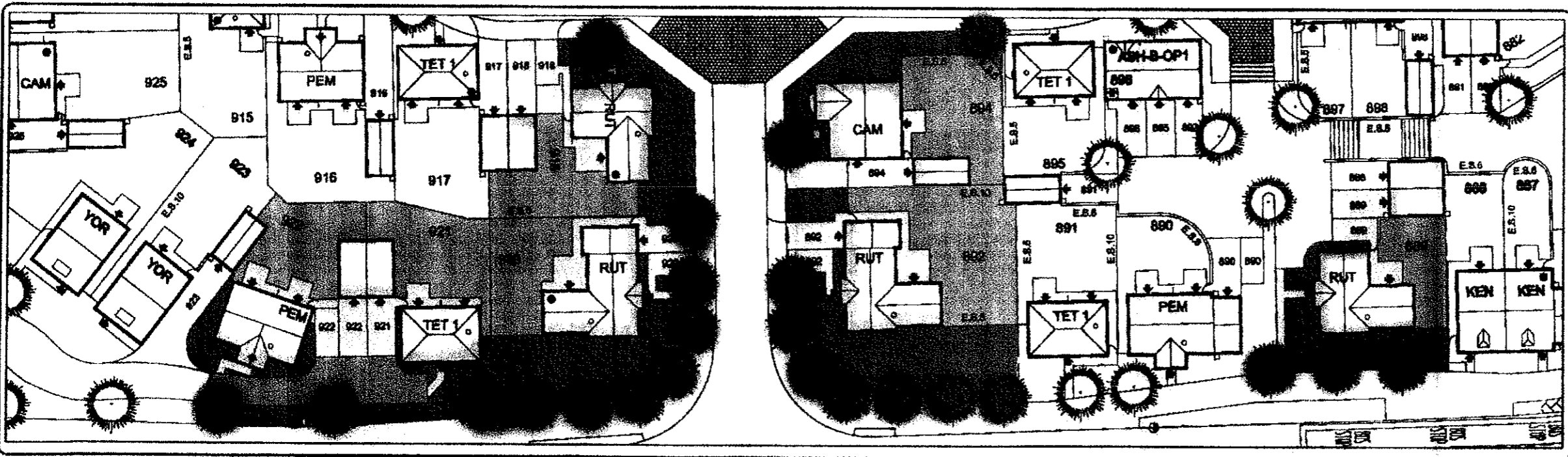
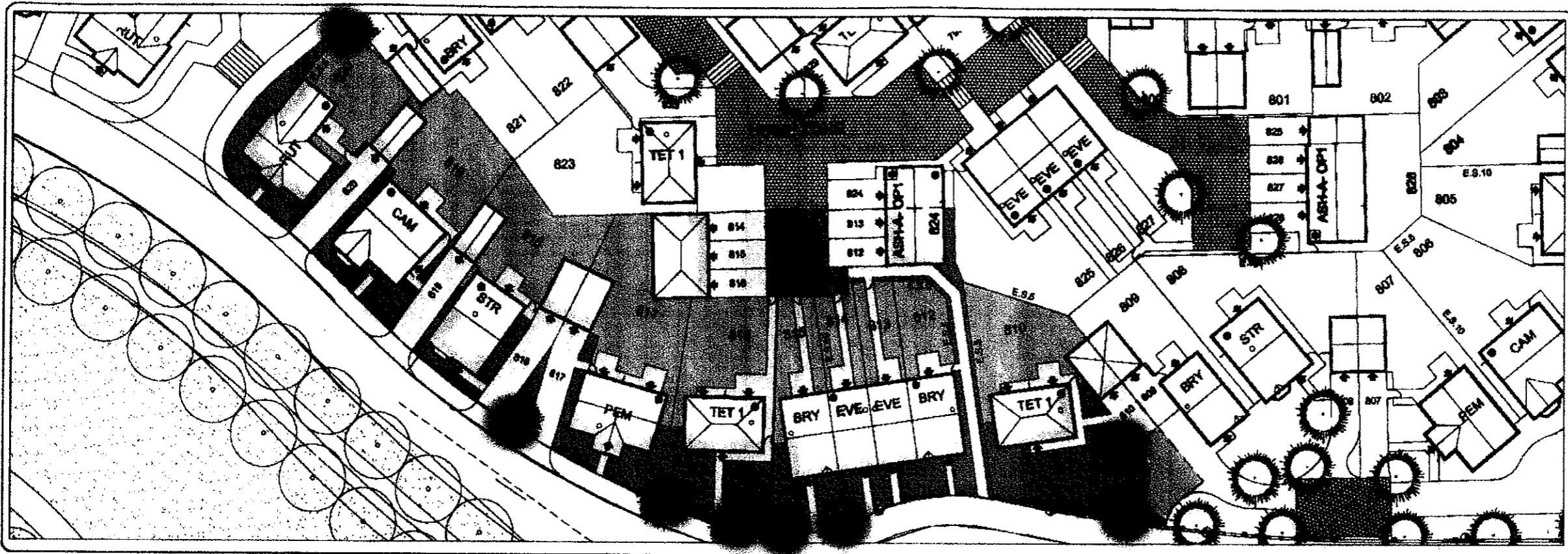

**Legend**

- Line to delineate plot boundaries. Refer to Boundary Treatment plan for type of wall/fence
- Location of plot entrance doors / garage doors
- Indicative position of new tree planting. Refer to Landscape Layout for further details.
- Existing trees to be retained. Trees to be topped, pruned and tidied up by specialist contractor

| Item | Description |
|------|-------------|
|------|-------------|

**Mix Schedule**

| House Type         | No Beds | Quantity  |
|--------------------|---------|-----------|
| <b>HOUSE TYPES</b> |         |           |
| The Broadway       | 3       | 02        |
| The Tetbury 1      | 3       | 03        |
| The Evesham        | 2       | 02        |
| The Pembroke       | 4       | 02        |
| The Ruthin         | 4       | 05        |
| The Cambridge      | 4       | 02        |
| The Stratford      | 4       | 01        |
| <b>TOTAL</b>       |         | <b>17</b> |

CHORLEY BOROUGH COUNCIL  
 Planning Department  
 - 2 NOV 2009  
 09/1797

A 29 10 09 Plans 894/815/890/817-820  
 included in red edge. HC  
 Revision Date Amendment Issues

**Development THE VILLAGE PH1 & 2**  
 Location: **Buckshaw Village, Chorley**  
 Planning Name:  
 Drawing Title: **PLANNING LAYOUT COLOURED**  
 Drawing Number: **BV - 11&2 - P02**  
 Revision: **A** Scale @ A3: **1:1250/1:500**  
 Drawn By: **HC** Date Issued: **OCT 09**  
 Checked by: \_\_\_\_\_ Date: \_\_\_\_\_

**REDROW HOMES**  
 Redrow Homes (Lancashire) Limited  
 Redrow Homes, 14 Edna Avenue, Buckshaw Village, Chorley, Lancashire, PR9 7PW  
 Tel: 01772 865700 Fax: 01772 865701 [www.redrow.co.uk](http://www.redrow.co.uk)

Legal Disclaimer: TEC  
 This layout has been prepared after due consideration of our Grids & Grids-to-Point

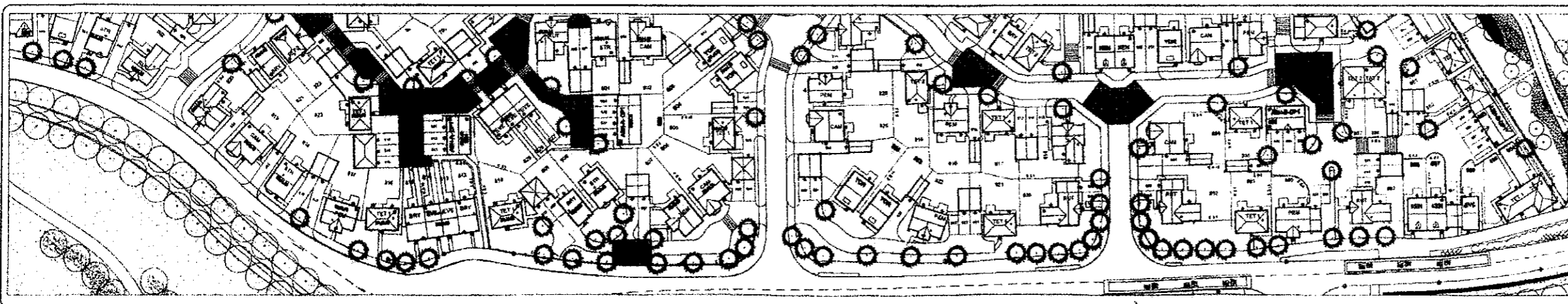
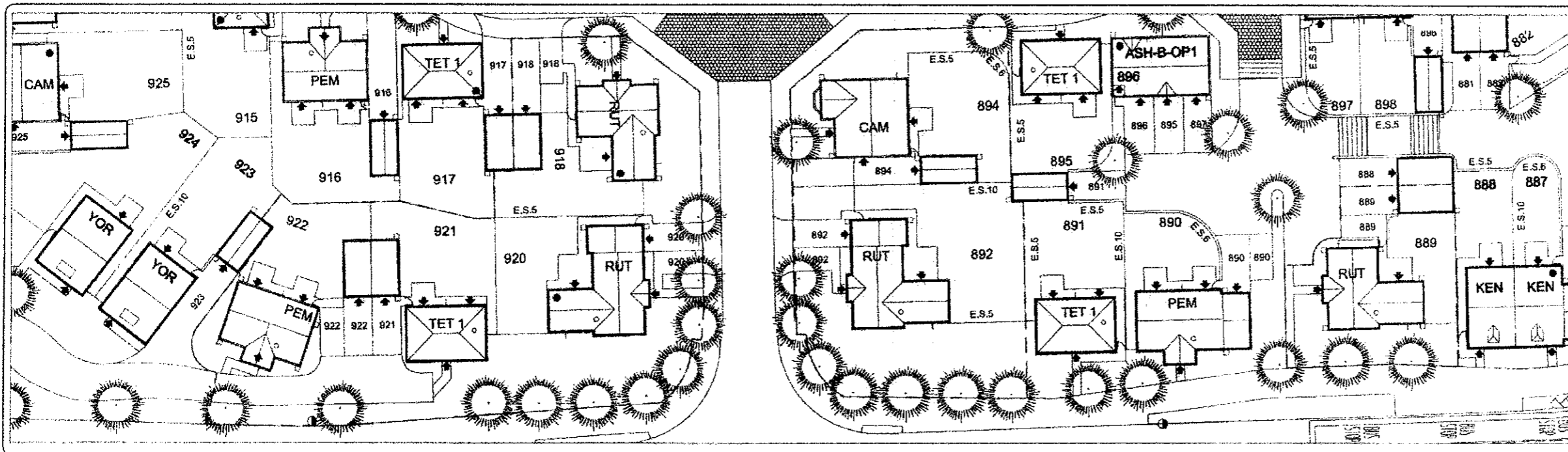
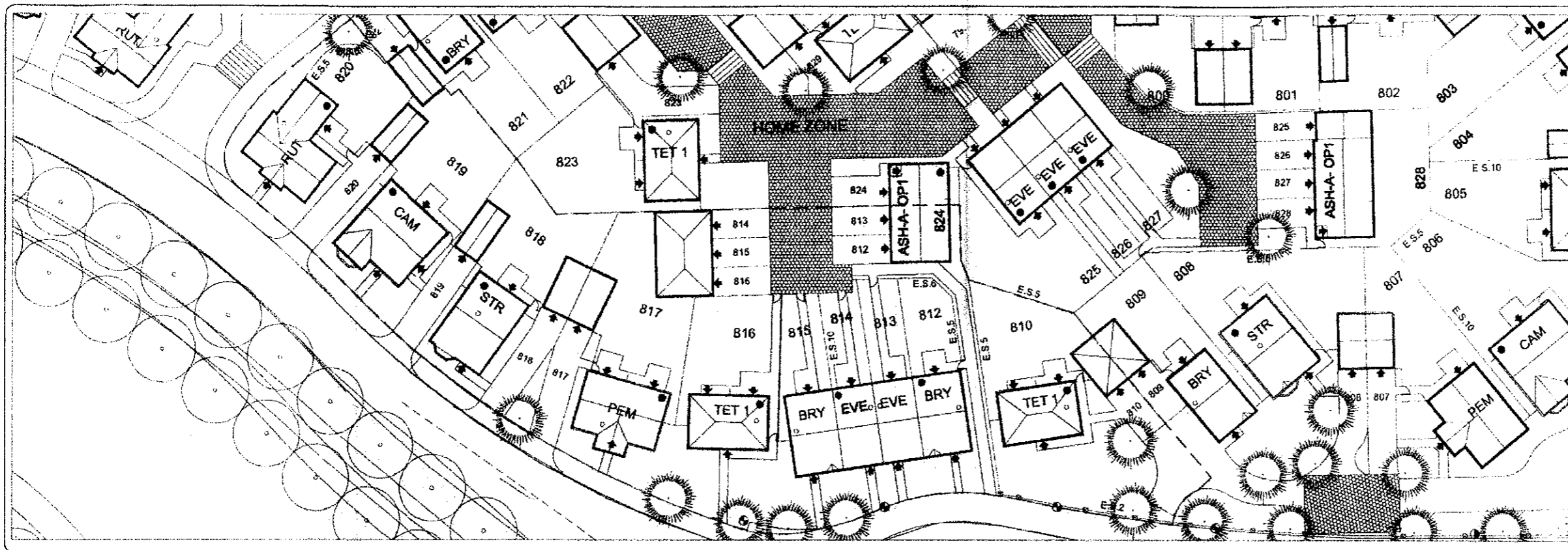

Survey Information

Legend

- Line to delineate plot boundaries. Refer to Boundary Treatment plan for type of wall/fence
- Location of plot entrance doors / garage doors
- Indicative position of new tree planting. Refer to Landscape Layout for further details.
- Existing trees to be retained. Trees to be topped, pruned and tidied up by specialist contractor

| Item | Description |
|------|-------------|
|      |             |

Mix Schedule

| House Type         | No Beds | Quantity  |
|--------------------|---------|-----------|
| <b>HOUSE TYPES</b> |         |           |
| The Broadway       | 3       | 02        |
| The Tetbury 1      | 3       | 03        |
| The Evesham        | 2       | 02        |
| The Pembroke       | 4       | 02        |
| The Ruthin         | 4       | 05        |
| The Cambridge      | 4       | 02        |
| The Stratford      | 4       | 01        |
| <b>TOTAL</b>       |         | <b>17</b> |

CHORLEY BOROUGH COUNCIL

2 NOV 2009

29 10 09 Plots 894/918/889/817-820  
Included in red edge

Revision: Date Amendment

Development: **THE VILLAGE PH1 & 2**

Location: Buckshaw Village, Chorley

Marketing Name:

Drawing Title: **PLANNING LAYOUT**

Drawing Number: **BV - 11&2 - P02**

Revision: **A** Scale: 1:1250/1:500

Drawn By: **HC** Date Started: **OCT 09**

Checked by:

**REDROW HOMES**

Redrow Homes (Lancashire) Limited

Redrow House, 14 Edon Avenue, Buckshaw Village, Chorley, Lancashire PR7 7NA  
Tel: 01772 543700 Fax: 01772 645721 Web: www.redrow.co.uk

Legal Disclaimer: This layout has been designed after due consideration of our Contract & Conditions Plan